



STATE OF NORTH CAROLINA
DEPARTMENT OF TRANSPORTATION

ROY COOPER
GOVERNOR

JAMES H. TROGDON, III
SECRETARY

March 8, 2019

ADDENDUM # 2

To: Plan Holders

From: Wes Jamison, P.E. 
Division 14 Project Manager

RE: **Revisions to a Sign Size in Traffic Management Plans
and Associated Quantity Adjustment**

Contract ID: DN00279
County: Macon
Letting Date: March 12, 2019

Plan sheets **TMP-2** and **TMP-3** have been revised to show a size change in a sign.
Please see the attached revised plan sheets.

Likewise, the associated quantity has been revised to reflect this change. Please see the
revised **Bid Item Sheets**.

Please access ebs addenda files on Bid Express®.

Thank you for your attention to this matter.

County : Macon

Line #	Item Number	Sec #	Description	Quantity	Unit Cost	Amount
ROADWAY ITEMS						
0001	0000100000-N	800	MOBILIZATION	Lump Sum	L.S.	
0002	0000400000-N	801	CONSTRUCTION SURVEYING	Lump Sum	L.S.	
0003	0030000000-N	SP	TYPE II MODIFIED APPROACH FILL, STATION ***** (STA. -L- 11+35.00)	Lump Sum	L.S.	
0004	0043000000-N	226	GRADING	Lump Sum	L.S.	
0005	0050000000-E	226	SUPPLEMENTARY CLEARING & GRUB- BING	0.25 ACR		
0006	0057000000-E	226	UNDERCUT EXCAVATION	50 CY		
0007	0195000000-E	265	SELECT GRANULAR MATERIAL	50 CY		
0008	0196000000-E	270	GEOTEXTILE FOR SOIL STABILIZA- TION	50 SY		
0009	1099700000-E	505	CLASS IV SUBGRADE STABILIZA- TION	50 TON		
0010	1121000000-E	520	AGGREGATE BASE COURSE	10 TON		
0011	1220000000-E	545	INCIDENTAL STONE BASE	10 TON		
0012	1491000000-E	610	ASPHALT CONC BASE COURSE, TYPE B25.0C	65 TON		
0013	1519000000-E	610	ASPHALT CONC SURFACE COURSE, TYPE S9.5B	80 TON		
0014	1575000000-E	620	ASPHALT BINDER FOR PLANT MIX	10 TON		
0015	3030000000-E	862	STEEL BEAM GUARDRAIL	12.5 LF		
0016	3045000000-E	862	STEEL BEAM GUARDRAIL, SHOP CURVED	12.5 LF		
0017	3150000000-N	862	ADDITIONAL GUARDRAIL POSTS	4 EA		
0018	3195000000-N	862	GUARDRAIL END UNITS, TYPE AT-1	1 EA		

County : Macon

Line #	Item Number	Sec #	Description	Quantity	Unit Cost	Amount
0019	3215000000-N	SP	GUARDRAIL ANCHOR UNITS, TYPE III	4 EA		
0020	3288000000-N	SP	GUARDRAIL END UNITS, TYPE TL-2	3 EA		
0021	3649000000-E	876	RIP RAP, CLASS B	5 TON		
0022	3656000000-E	876	GEOTEXTILE FOR DRAINAGE	60 SY		
0023	4400000000-E	1110	WORK ZONE SIGNS (STATIONARY)	368.5 SF		
0024	4410000000-E	1110	WORK ZONE SIGNS (BARRICADE MOUNTED)	94 SF		
0025	4445000000-E	1145	BARRICADES (TYPE III)	64 LF		
0026	4810000000-E	1205	PAINT PAVEMENT MARKING LINES (4")	1,600 LF		
0027	6000000000-E	1605	TEMPORARY SILT FENCE	585 LF		
0028	6009000000-E	1610	STONE FOR EROSION CONTROL, CLASS B	30 TON		
0029	6012000000-E	1610	SEDIMENT CONTROL STONE	45 TON		
0030	6015000000-E	1615	TEMPORARY MULCHING	0.5 ACR		
0031	6018000000-E	1620	SEED FOR TEMPORARY SEEDING	100 LB		
0032	6021000000-E	1620	FERTILIZER FOR TEMPORARY SEEDING	0.5 TON		
0033	6024000000-E	1622	TEMPORARY SLOPE DRAINS	200 LF		
0034	6029000000-E	SP	SAFETY FENCE	600 LF		
0035	6030000000-E	1630	SILT EXCAVATION	20 CY		
0036	6036000000-E	1631	MATTING FOR EROSION CONTROL	750 SY		
0037	6037000000-E	SP	COIR FIBER MAT	100 SY		
0038	6042000000-E	1632	1/4" HARDWARE CLOTH	95 LF		

County : Macon

Line #	Item Number	Sec #	Description	Quantity	Unit Cost	Amount
0039	6070000000-N	1639	SPECIAL STILLING BASINS	1		
					EA	
0040	6071020000-E	SP	POLYACRYLAMIDE (PAM)	10		
					LB	
0041	6084000000-E	1660	SEEDING & MULCHING	0.5		
					ACR	
0042	6087000000-E	1660	MOWING	0.5		
					ACR	
0043	6090000000-E	1661	SEED FOR REPAIR SEEDING	50		
					LB	
0044	6093000000-E	1661	FERTILIZER FOR REPAIR SEEDING	0.25		
					TON	
0045	6096000000-E	1662	SEED FOR SUPPLEMENTAL SEEDING	50		
					LB	
0046	6108000000-E	1665	FERTILIZER TOPDRESSING	0.25		
					TON	
0047	6114500000-N	1667	SPECIALIZED HAND MOWING	10		
					MHR	
0048	6117000000-N	SP	RESPONSE FOR EROSION CONTROL	13		
					EA	
0049	6117500000-N	SP	CONCRETE WASHOUT STRUCTURE	1		
					EA	

STRUCTURE ITEMS

0050	8035000000-N	402	REMOVAL OF EXISTING STRUCTURE AT STATION ***** (STA. -L- 11+35.00)	Lump Sum	L.S.	
0051	8065000000-N	SP	ASBESTOS ASSESSMENT	Lump Sum	L.S.	
0052	8121000000-N	412	UNCLASSIFIED STRUCTURE EXCAVATION AT STATION ***** (STA. -L- 11+35.00)	Lump Sum	L.S.	
0053	8182000000-E	420	CLASS A CONCRETE (BRIDGE)	38.6		
					CY	
0054	8210000000-N	422	BRIDGE APPROACH SLABS, STATION ***** (STA. -L- 11+35.00)	Lump Sum	L.S.	
0055	8217000000-E	425	REINFORCING STEEL (BRIDGE)	4,734		
					LB	

County : Macon

Line #	Item Number	Sec #	Description	Quantity	Unit Cost	Amount
0056	8328200000-E	450	PILE DRIVING EQUIPMENT SETUP FOR *** STEEL PILES (HP 12X53)	10		EA
0057	8364000000-E	450	HP12X53 STEEL PILES	190		LF
0058	8505000000-E	460	VERTICAL CONCRETE BARRIER RAIL	90		LF
0059	8608000000-E	876	RIP RAP CLASS II (2'-0" THICK)	167		TON
0060	8622000000-E	876	GEOTEXTILE FOR DRAINAGE	129		SY
0061	8657000000-N	430	ELASTOMERIC BEARINGS	Lump Sum		L.S.
0062	8762000000-E	430	3'-0" X 1'-9" PRESTRESSED CONC CORED SLABS	405		LF

1257/Mar08/Q11038.85/D300887420000/E62

Total Amount Of Bid For Entire Project :

SIGN NUMBER: - TYPE: D QUANTITY: 1 SIGN WIDTH: 4'-6" HEIGHT: 2'-6" TOTAL AREA: 11.25 Sq.Ft. BORDER TYPE: FLUSH RECESS: 0.47" WIDTH: 0.63" RADII: 1.5" NO. Z BARS: - LENGTH: -	BACKG COLOR: Orange COPY COLOR: Black	DESIGN BY: NLG PROJECT ID: -	CHECKED BY: DIV: -	DATE:																																													
<table border="1" style="width: 100%; border-collapse: collapse;"> <thead> <tr> <th>SYMBOL</th> <th>X</th> <th>Y</th> <th>WID</th> <th>HT</th> </tr> </thead> <tbody> <tr><td> </td><td> </td><td> </td><td> </td><td> </td></tr> <tr><td> </td><td> </td><td> </td><td> </td><td> </td></tr> <tr><td> </td><td> </td><td> </td><td> </td><td> </td></tr> <tr><td> </td><td> </td><td> </td><td> </td><td> </td></tr> <tr><td> </td><td> </td><td> </td><td> </td><td> </td></tr> <tr><td> </td><td> </td><td> </td><td> </td><td> </td></tr> <tr><td> </td><td> </td><td> </td><td> </td><td> </td></tr> <tr><td> </td><td> </td><td> </td><td> </td><td> </td></tr> </tbody> </table>		SYMBOL	X	Y	WID	HT																																											
SYMBOL	X	Y	WID	HT																																													
NOTES 1. Background shall be NC Grade B reflective sheeting. 2. Legend and border shall be direct applied NC Grade B sheeting.																																																	

Spacing Factor is 1 unless specified otherwise

LETTER POSITIONS

Letter spacings are to start of next letter																				Series/Size Text Length			
R	I	V	E	R	B	E	N	D													D 2000 43.1		
5.4	5.5	2.1	5.6	4.8	5.5	5.5	4.8	5.5	4.0	5.4													D 2000 9.5
R	D																						
22.3	5.5	4.0	22.3																				

FILENAME: NORTH CAROLINA D.O.T. SIGN DETAIL

3/7/2019 10:06:37 AM \$PENTBL\$ G:\CKE Projects\CKE21004 Limited Services Division Offices\Group 3\550120\Roadway\Proj\550120.RDY_06_TMP2.dgn

DOCUMENT NOT CONSIDERED FINAL
UNLESS ALL SIGNATURES COMPLETED

LOUIS BERGER
1001 Wade Avenue, Suite 400
Raleigh, NC 27605-3322
License No.: F-0840

APPROVED: _____	DATE: _____

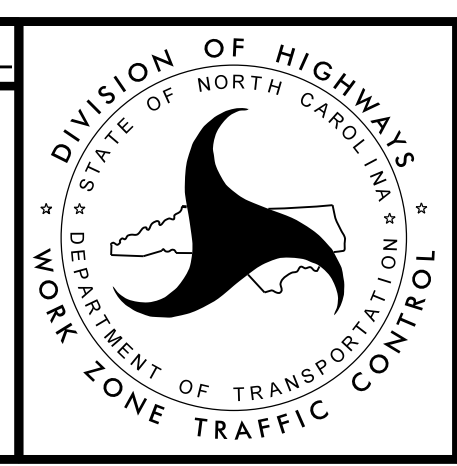

SPECIAL SIGN DESIGN

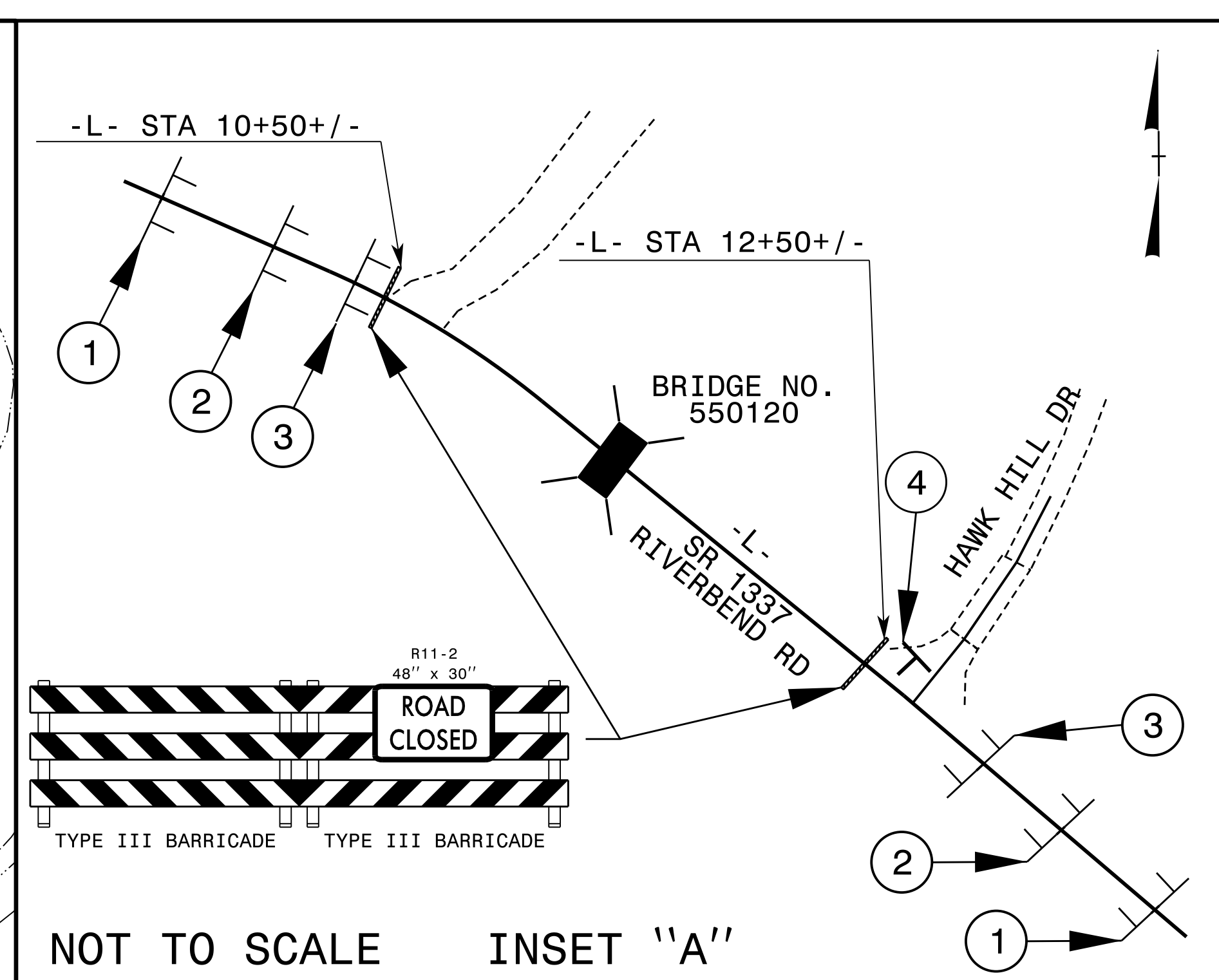
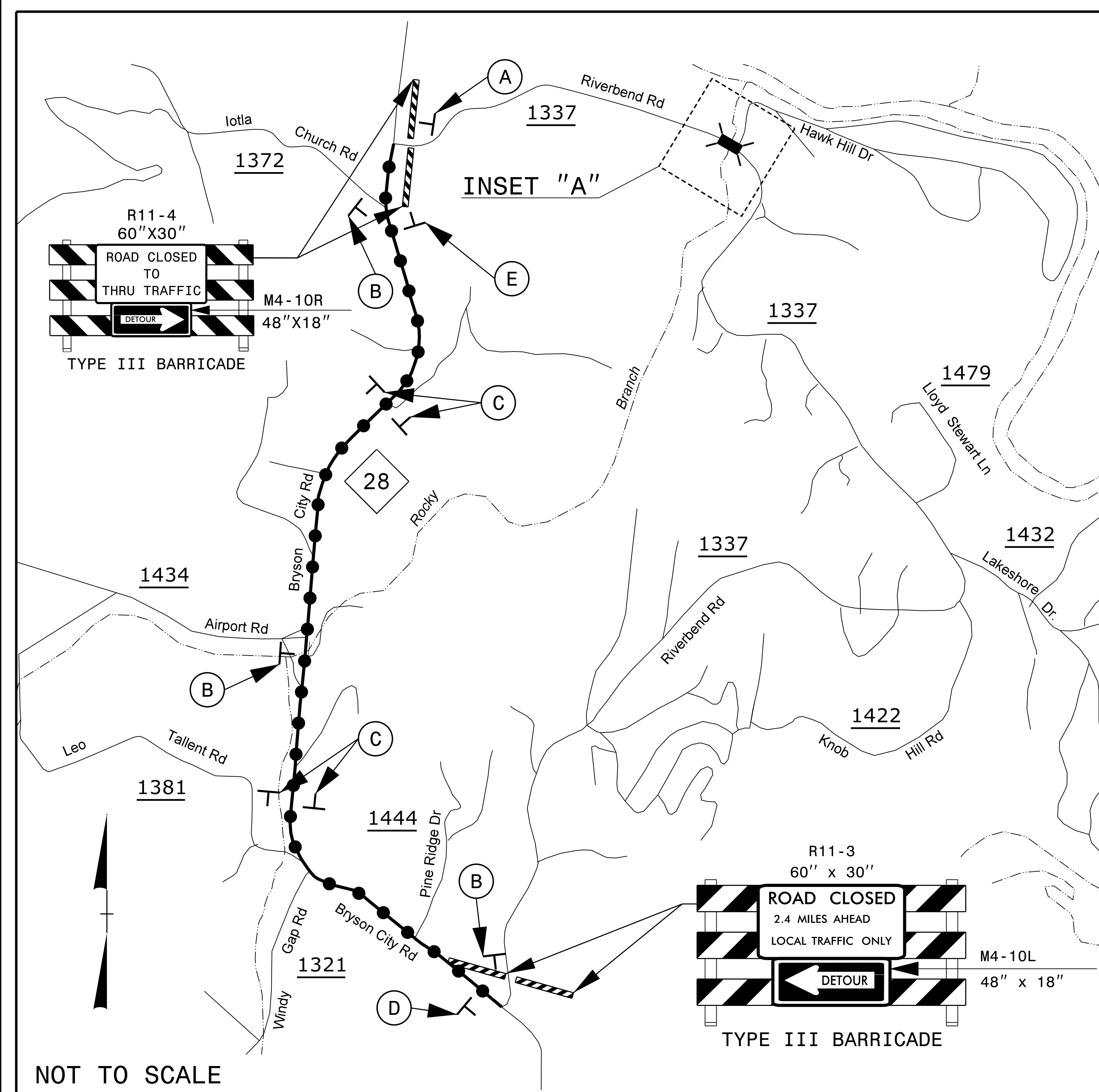

PROJECT PHASING

- STEP 1:**
 - INSTALL OFF-SITE DETOUR AND ROAD CLOSURE SIGNING (PROVIDED BY CONTRACTOR).
 - USING RDWY STD 1101.03, SHEET 1 OF 9, CLOSE SR 1337 (RIVERBEND RD.) TO THRU TRAFFIC FROM -L- STA. 10+50+/- TO -L- STA. 12+50+/- AND PLACE TRAFFIC ONTO OFF SITE DETOUR AS SHOWN.
- STEP 2:**
 - REMOVE EXISTING BRIDGE No. 550120 AND APPROACHES AND CONSTRUCT THE PROPOSED BRIDGE AND ROADWAY UP TO AND INCLUDING THE FINAL LAYER OF SURFACE COURSE FROM -L- STA. 10+50+/- TO -L- STA. 12+50+/- . PLACE FINAL PAVEMENT MARKINGS ON -L- (SEE CONSTRUCTION PLANS).
- STEP 3:**
 - REMOVE ALL TRAFFIC CONTROL DEVICES, SIGNING, AND DETOUR ROUTE SIGNING.
 - OPEN TRAFFIC TO FINAL TRAFFIC PATTERN.

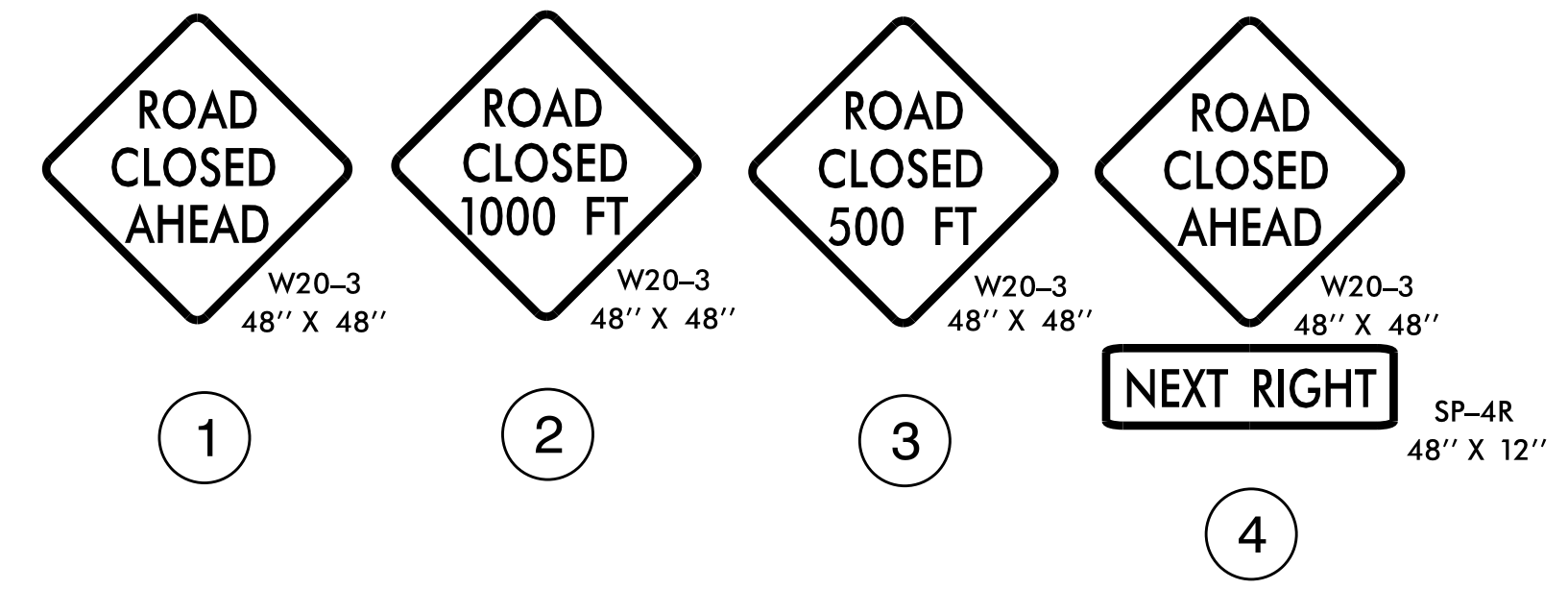

- NOTES:**
- ALL DETOUR SIGN LOCATIONS ARE APPROXIMATE. FOR SIGNS 1-4, SEE ROADWAY STANDARD DRAWING NO. 1101.03, SHEET 1 OF 9 FOR SIGN PLACEMENT AND APPLICABLE NOTES.
 - ALL DETOUR SIGNS ARE BLACK ON ORANGE UNLESS OTHERWISE NOTED.
 - MAINTAIN ACCESS TO ADJACENT DRIVEWAYS AT ALL TIMES.

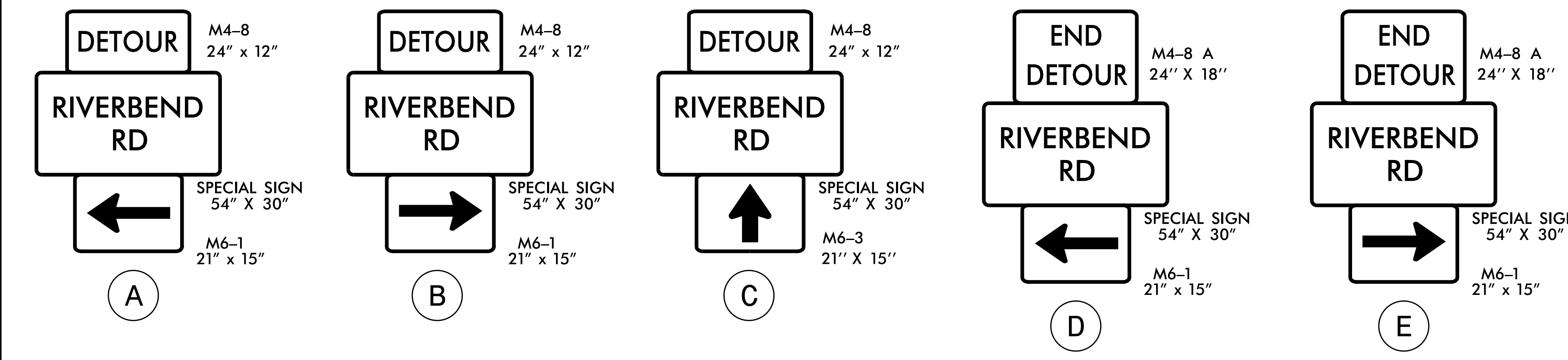

DOCUMENT NOT CONSIDERED FINAL UNLESS ALL SIGNATURES COMPLETED

APPROVED: _____ DATE: _____

DocuSigned by:
 RD Odell
 7814D0772012EA

SEAL
 NORTH CAROLINA PROFESSIONAL ENGINEER
 R. D. ODELL
 27933
 3/7/2019

DIVISION OF HIGHWAYS
 NORTH CAROLINA
 DEPARTMENT OF TRANSPORTATION
 WORK ZONE TRAFFIC CONTROL

LOUIS BERGER
 1001 Wade Avenue, Suite 400
 Raleigh, NC 27605-3322
 License No.: F-0840

TEMPORARY TRAFFIC CONTROL PHASING

3/7/2019 9:53:19 AM
 SPENTBLB
 G:\GKE Projects\CKE21004 Limited Services\Division Of Highways\Group 3\550120\Roadway\Proj\550120_RDY_06_TMP3.dgn